

Service

EMERALD S 6C

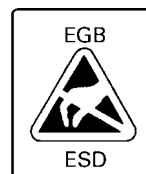

BTE instruments utilize electrostatic sensitive devices (ESD) which are very sensitive to static charges and may be destroyed by such charges. All work on open hearing instruments therefore requires workplaces at which ESD regulations can be implemented to prevent the accumulation of static charges. This also applies to replacement of the housing!



Tools

Tools usually used for servicing and repairing hearing instruments.

EMERALD S 80 6C

10941328 beige
10941907 granite
10941908 grey
10941906 brown
10941911 silver
10941909 pearl white
10941910 sandy brown
10941905 dark granite

EMERALD S 60 6C

10941912 beige
10941915 granite
10941916 grey
10941914 brown
10941919 silver
10941917 pearl white
10941918 sandy brown
10941913 dark granite

EMERALD S 40 6C

10941920 beige
10941923 granite
10941924 grey
10941922 brown
10941927 silver
10941925 pearl white
10941926 sandy brown
10941921 dark granite

EMERALD S 6C

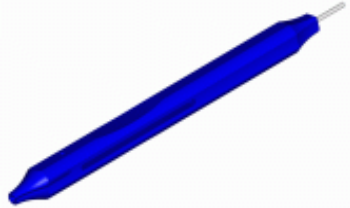
Order No.	Description	
Instrument		
10827885	CC-KIT H2922 RX EMERALD S BG	
10827887	CC-KIT H2922 RX EMERALD S BRN	
10942949	CC-KIT H2922 RX EMERALD S DGT	
10827888	CC-KIT H2922 RX EMERALD S GNT	
10827889	CC-KIT H2922 RX EMERALD S GR	
10827890	CC-KIT H2922 RX EMERALD S PRL	
10827891	CC-KIT H2922 RX EMERALD S SB	
10827892	CC-KIT H2922 RX EMERALD S SLV	
10600047	TOOL REMOVAL H2770 BLU	

EMERALD S 6C

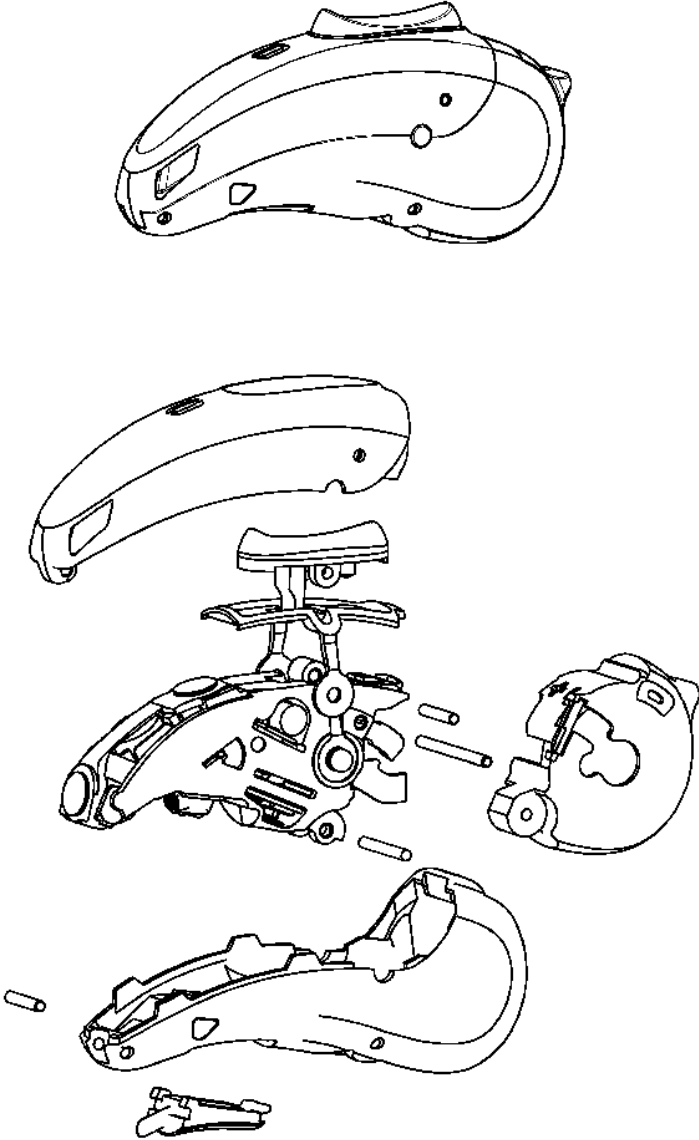

EMERALD S 6C

Order No.	Description	
-----------	-------------	--

Amplifier

10942799	SERV NT-BASE EMERALD S 80 6C	
10942795	SERV NT-BASE EMERALD S 60 6C	
10942790	SERV NT-BASE EMERALD S 40 6C	

Accessories

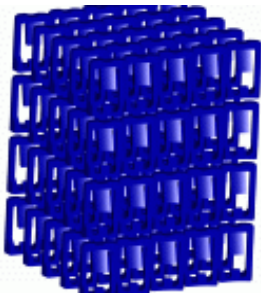
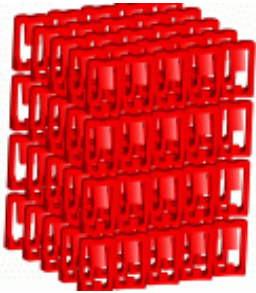
10670893	MEASURING CARD CLICK MOLD REC3	
10419704	SERVICE INDICATOR CLIP SET BLU	
10419705	SERVICE INDICATOR CLIP SET RED	
10426987	ADAPTER CONCHA LOCK S TR	
10673516	ACCESSORY CONCHA LOCK P TR	
10827324	BOX HF4 PRO CXX FILTER RD / BL	
10426013	CLICK DOME 10MM CLOSED CXX TR	
10426019	CLICK DOME 10MM DOUBLE CXX TR	
10426015	CLICK DOME 10MM OPEN CXX TR	
10426016	CLICK DOME 4MM OPEN CXX TR	
10426017	CLICK DOME 6MM CLOSED CXX TR	

Legal Manufacturer
Sivantos GmbH
Henri-Dunant-Strasse 100
91058 Erlangen, Germany

<http://www.rexton.com>

Reference number:
D00153177

Replaces edition:
-

Edition:
2016-09-29

EMERALD S 6C

Order No.	Description	
Accessories		
10426012	CLICK DOME 8MM CLOSED CXX TR	
10426018	CLICK DOME 8MM DOUBLE CXX TR	
10426014	CLICK DOME 8MM OPEN CXX TR	
10670790	CLICK DOME SEMI OPEN CXX TR	
10174571	GAUGE TEMPLATE CXX (PR) GR	
10419685	INDICATOR CLIP SET	
10937826	KIT CONCHA LOCK M ERU3G1 TR	
10824820	MINIREC. 2.0 0L M CXX	
10824821	MINIREC. 2.0 0R M CXX	
10824822	MINIREC. 2.0 1L M CXX	
10824823	MINIREC. 2.0 1R M CXX	
10824824	MINIREC. 2.0 2L M CXX	
10824825	MINIREC. 2.0 2R M CXX	
10824826	MINIREC. 2.0 3L M CXX	
10824827	MINIREC. 2.0 3R M CXX	
10933054	MINIREC. 2.0 4L M CXX	
10933053	MINIREC. 2.0 4R M CXX	
10670779	MINIREC. 2.0 FITTING SET CXX	
10669923	MINIREC. 2.0 P 0L CXX	
10669924	MINIREC. 2.0 P 0R CXX	
10669925	MINIREC. 2.0 P 1L CXX	
10669926	MINIREC. 2.0 P 1R CXX	
10669927	MINIREC. 2.0 P 2L CXX	
10669928	MINIREC. 2.0 P 2R CXX	
10669929	MINIREC. 2.0 P 3L CXX	
10669930	MINIREC. 2.0 P 3R CXX	
10669907	MINIREC. 2.0 S 0L CXX	

Legal Manufacturer
Sivantos GmbH
Henri-Dunant-Strasse 100
91058 Erlangen, Germany

<http://www.rexton.com>

Reference number:
D00153177

Replaces edition:
-

Edition:
2016-09-29

EMERALD S 6C

Order No.	Description	
-----------	-------------	--

Accessories

10669908	MINIREC. 2.0 S 0R CXX	
10669909	MINIREC. 2.0 S 1L CXX	
10669910	MINIREC. 2.0 S 1R CXX	
10669911	MINIREC. 2.0 S 2L CXX	
10669912	MINIREC. 2.0 S 2R CXX	
10669913	MINIREC. 2.0 S 3L CXX	
10669914	MINIREC. 2.0 S 3R CXX	
10824469	PROGRAMMING ADADTOR SIZE 312	
10671378	SERV. RS SEALING H2820 TR	
10598984	SET CLICK MOLD SERVICE	
10674370	TOOL MINI RECEIVER 2.0	