

# rabbit

## Exploded views / Part lists

Rev. date (11.2017)

*On the following pages you will find the parts used to assemble this product. Please note that some spare parts cannot be purchased individually but are part of a complete kit. Please also note that for some spare parts extra delivery time may occur.*



## Contents

Rabbit and tray.....	3
Foot plates, foot supports and knee supports.....	6
Chest supports, back supports, head support .....	10

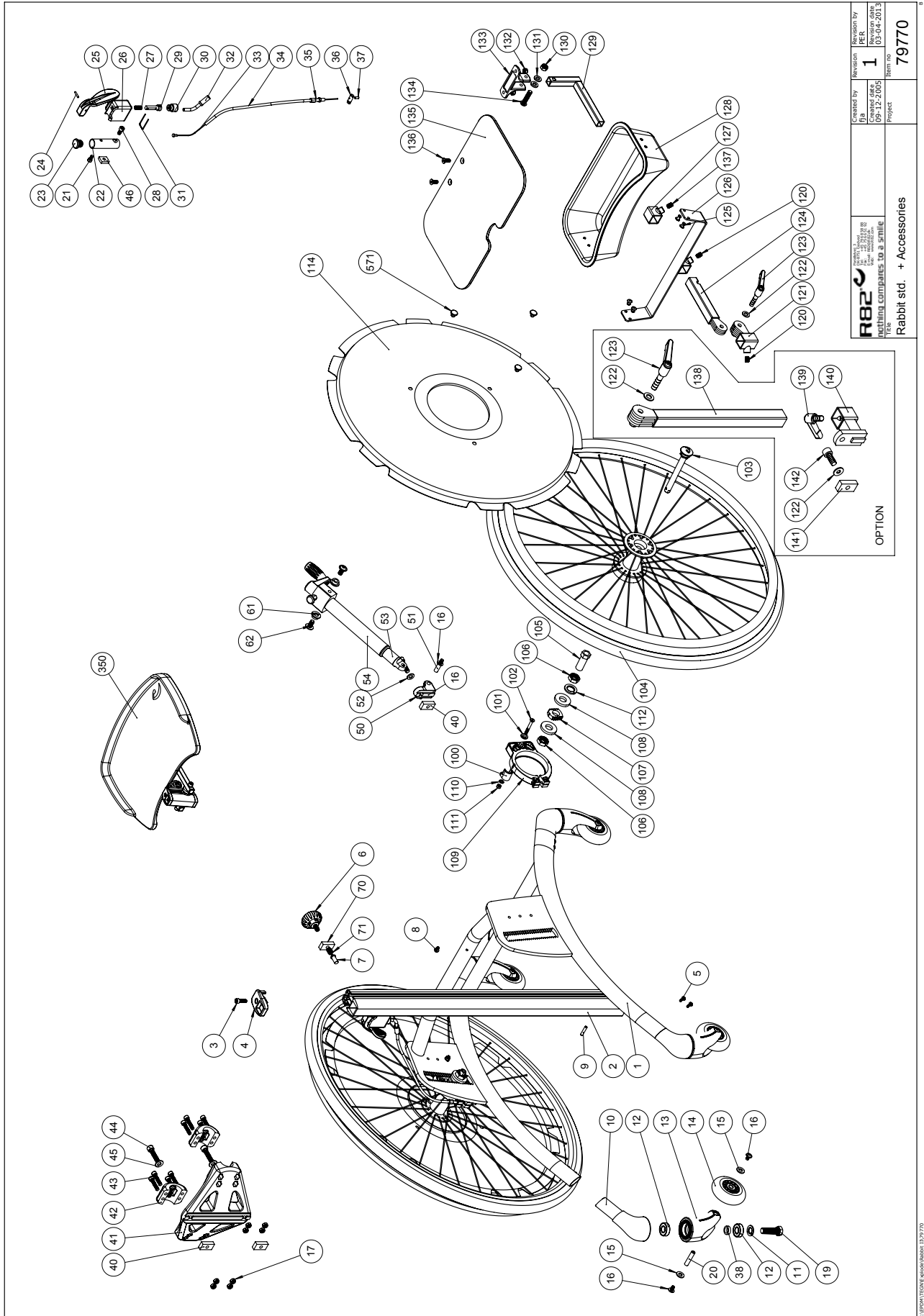

Created by JYBA	Revision 1	Revision by JYBA	Item no. 79770
Drawn date 09-12-2005		Drawn date 03-04-2013	
R82 Nothing compares to a smile		Rabbit std. + Accessories	

Position	No.	Description	Quantity	Unit of Measure	Ean code
1	72951-31	Stand support frame 1, red	1	PCS	5707292762962
1	72952-32	Rabbit frame size 2, blue	1	PCS	5707292762931
1	72953-54	Rabbit frame size 3, silver	1	PCS	5707292433183
2	73621	Profile size 1, 500 mm	1	PCS	5707292435965
2	73622	Profile size 2, 700 mm	1	PCS	5707292435972
2	73623	Profile size 3, 800 mm	1	PCS	5707292435989
2	73624	Profile size 4, 1000	1	PCS	5707292435996
3	0602200	Insex screw 6*16	1	PCS	5707292138095
4	72610	Plug for pile	1	PCS	5707292420718
5	1940034	Eco-drill M4,2*22	8	PCS	5707292423115
6	3502545	R82 handle dia.45 M8*15mm	1	PCS	5707292450456
7	72611	Trust pad	1	PCS	5707292450500
8	1902730	Crosshead screw M5*10, FZB	2	PCS	5707292433084
9	0589230	Stainless spring pin 5*30	1	PCS	5707292436603
16	0659010	Button head with flange M6*10	2	PCS	5707292356819
17	1606500	LOCK NUT 6 MM	8	PCS	5707292141361
21,33 and 46	5086110	Handgrip f. Brake comp.rabbit	2	PCS	5707292458209
32	0389000	Angled cable tightener, 45°	2	PCS	5707292136152
34	5002997	Braking cable, rabbit, 35 cm	2	PCS	5707292436009
34	5001600	Cable for back new Rabbit	2	PCS	5707292154491
34	5002756	Cable for recline, outer 1-4	2	PCS	5707292413673
35	0380000	Cable tighter M5*23	2	PCS	5707292135933
36	0380100	Clip for cable	2	PCS	5707292136015
37	0387000	End nipple for outer casing	2	PCS	5707292136091
40	72694	Slidebar	3	PCS	5707292407931
41+42	5086120	Mounting plate w/bearing shell	1	SET	5707292497253
43	0602401	Insex screw 6*30	8	PCS	5707292138125
44	0603000	Insex screw 8*35	2	PCS	5707292138217
45	1102010	Face plate 8,4*18*2mm, FZB	2	PCS	5707292429766
50	72701	Knee joint	1	PCS	5707292420824
51	72702	Shaft	1	PCS	5707292407924
52	1103200	Fazet washer 8mm	1	PCS	5707292140296
53	0602600	Insex 8*30	1	PCS	5707292138170
54	5086100	Spindel mounted toucan/rabbit	1	PCS	5707292420817
61	72878	Bush for holder	2	PCS	5707292418678
62	0661501	Button head w/flange 8x16	2	PCS	5707292139566
70	72694	Slidebar	1	PCS	5707292407931
71	0310521	Compression spring 1.2*8	1	PCS	5707292450463
100	72960	Stabilizer for Rabbit brake	2	PCS	5707292439963
101	72979	Washer f/5mm countersunk screw	2	PCS	5707292433404
102	0609724	Insex 5*40 uh. Fzb	2	PCS	5707292434999
103	2985090	Stainless q-release, Rabbit	2	PCS	5707292436498
104	3302622-2	22" Wheel fo Rabbit w/flexel	2	PCS	5707292596697
104	3302624-2	24" Wheel for rabbit, w/flexel	2	PCS	5707292596628
104	3302626-2	26" Wheel for rabbit, w/flexel	2	PCS	5707292596680
104	3302629-3	29" Wheel for rabbit, w/pur	2	PCS	5707292591142
104	3302632-2	32" RABBIT WHEEL WITH PUR	2	PCS	5707292596598
104	3302636-2	36" FOR RABBIT W/PUR	2	PCS	5707292596253

105, 106, 108 and 112	5086111	Bush for Rabbit Module	2	PCS	5707292540355
107	72977	Height regulation disc	2	PCS	5707292428790
109	2983060	Band brake wo/washer, Rabbit	2	PCS	5707292436528
110	1102900	Fazet washer 5 mm	2	PCS	5707292140272
111	1606300	Lock nut 5 mm	2	PCS	5707292141354
112	1101650	CENTER SPRING WASHER 16MM	PCS	2	5707292140203
114	2983240	22" SPOKEPROTECTOR, CLEAR	PCS	2	5707292444332
114	2983230	24" SPOKEPROTECTOR, CLEAR	PCS	2	5707292444325
114	2983220	26" SPOKEPROTECTOR, CLEAR	PCS	2	5707292440105
114	2983250	29" SPOKEPROTECTOR, CLEAR	PCS	2	5707292449924
114	2983260	32" SPOKEPROTECTOR, CLEAR	PCS	2	5707292449931
114	2983270	36" SPOKEPROTECTOR, CLEAR	PCS	2	5707292449948
120	0808020	Stainless stopscrew,M8*12	2	PCS	5707292140074
121	72955	Tube size 1,mobil frame, 425mm	1	PCS	5707292417329
122	1102000	Planing washer 8mm	1	PCS	5707292140227
123	3502630	Tightning handle 65 mm,M8*30mm	1	PCS	5707292436801
124	73233	Adjustment arm, short	1	PCS	5707292109040
125	0506500	Blind rivet 4,8*12 all/sizes	4	PCS	5707292137296
126	73237-1	Mounting for table	1	PCS	5707292435378
127	81164-66	Holder for footsupport,impala	1	PCS	5707292227218
128	76490	Toy-box for Rabbit	1	PCS	5707292533371
129	73235	Bar for table	1	PCS	5707292109064
130	1607000	Lock nut 8mm, large pack	1	PCS	5707292141378
131	1310650	Distance piece, o16*8,5*2,5mm	2	PCS	5707292140777
132	1606500	Lock nut 6 mm	2	PCS	5707292141361
133	81712	Back mounting for Panda 1-4	1	PCS	5707292118011
134	0603200	Insex screw 8*40	1	PCS	5707292138224
135	73238	Tableplate f. New Rabbit	1	PCS	5707292109088
136	0621600	Insex screw counters. 6*16	2	PCS	5707292138965
137	0808022	Stainless stopscrew M8*16	1	PCS	5707292140081
138	73256	JUSTERINGSARM F. BORD	1	PCS	5707292501585
139	3502600	Tightening handle 65mm M8*16	1	PCS	5707292146922
140	80285	Moount.bracket for table weld.	1	PCS	5707292491060
141	72694	Slidebar	1	PCS	5707292407931
142	0602800	Insex screw 8*20	1	PCS	5707292138194
571	2982401	CLIPS FOR SPOKE GUARDS, BLACK	PCS	3	5707292427670

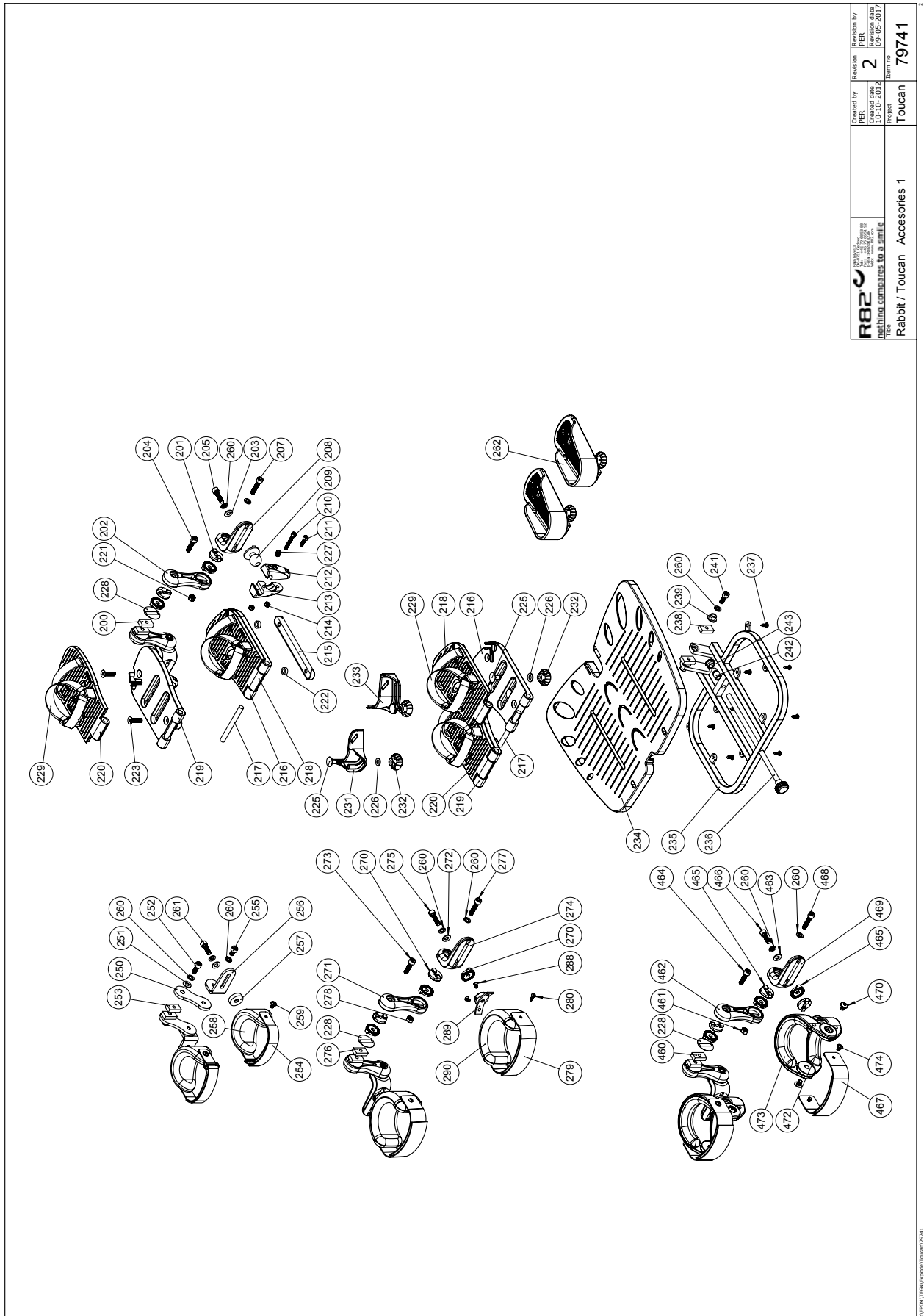

 R82 A/S Parallelvej 3 8751 Gedved Denmark	Created by PER	Revision 2	Revision by PER
	Created date 10-10-2012	Revision date 09-05-2017	Revision no. 79741
Project Toucan		Accessories 1	

Position	No.	Description	Quantity	Unit of Measure	Ean code
200	72694	Slidebar	2	PCS	5707292407931
201	74062	Toothed disk 30*14	8	PCS	5707292377951
202	72712	Knee joint	2	PCS	5707292420756
203	1102010	Face plate 8,4*18*2mm, FZB	2	PCS	5707292429766
204	0602600	Insex 8*30	2	PCS	5707292138170
205	0602700	Insex screw 8*25	2	PCS	5707292138187
207	0603000	Insex screw 8*35	2	PCS	5707292138217
208	72713	Bracked	2	PCS	5707292420763
209	72721	Ballhead	2	PCS	5707292428875
210	0602440	Insex M6*40 FZB	2	PCS	5707292138149
211	0602300	Insex screw 6*20	2	PCS	5707292138101
212	72723	Ball joining left	2	PCS	5707292421814
213	72724	Ball joining right	2	PCS	5707292421845
214	1606500	Lock nut 6 mm	4	PCS	5707292141361
215	72722	Bracket for flip upp sandal	2	PCS	5707292406163
216	72934	Footplate size 1, right, fixed	1	PCS	5707292428905
216	72937	Footplate size 2, right, fixed	1	PCS	5707292428950
216	72940	Footplate size 3, left, mobile	1	PCS	5707292438959
217	72709	Shaft size 1, flip upp	2	PCS	5707292428981
217	72708	Shaft size 2, flip upp	2	PCS	5707292428998
217	72707	Shaft size 3, flip up	2	PCS	5707292440730
218	72933	Footplate size 1, right,mobile	1	PCS	5707292428899
218	72938	Footplate size 2, right,mobile	1	PCS	5707292428967
218	72942	Footplate size 3, right	1	PCS	5707292438928
219	72932	Footplate size 1, left, fixed	1	PCS	5707292428929
219	72935	Footplate size 2, left, fixed	1	PCS	5707292428936
219	72939	Footplate size 3, left	1	PCS	5707292438935
220	72931	Footplate size 1, left, mobile	1	PCS	5707292428912
220	72936	Footplate size 2, left, mobile	1	PCS	5707292428943
220	72941	Footplate size 3, right, fixed	1	PCS	5707292438942
221	1607000	Lock nut 8mm, large pack	2	PCS	5707292141378
222	1310541	Distance piece 1878,2*5mm	4	PCS	5707292429926
223	0625000	Insex screw counters. 8*30	4	PCS	5707292139085
225	1905600	Board bolt 8*30mm	4	PCS	5707292142337
226	1102010	Face plate 8,4*18*2mm, FZB	4	PCS	5707292429766
227	0701010	Set screw M10*10 w/flat end	2	PCS	5707292434098
228	72717	Disk for footrest	2	PCS	5707292434760
229	5540520	Footstrap for flip up size 1	1	SÆT	5707292435538
229	5540525	Footstrap for flip up size 2+3	1	SÆT	5707292435545
229	5540530	Footstrap for flip up size 3	1	SÆT	5707292438171
231	72696	Heelunit, heelsupport	1	PCS	5707292421715
231	72710	HEEL SUPPORT SIZE 2	1	PCS	5707292436832
232	3501501	R82 handle M8*15mm nut	4	PCS	5707292413949
233	72697	Heelunit, heelsupport	1	PCS	5707292421722
233	72711	Heel support size 2	1	PCS	5707292436849
234	72685	Footplate size 1, Toucan	1	PCS	5707292420596
234	72684	Footplate size 2, Toucan	1	PCS	5707292420626
235	72690	Carryprofile, size 1 footlate	1	PCS	5707292420572
235	72681	Carryprofile, size 2 footplate	1	PCS	5707292406231

236	3502790	Hand grip 28mm, M10*196mm	1	PCS	5707292363152
236	72698	Spindle, footrest size 2	1	PCS	5707292420787
237	1940027	Ecosyn phx 5*14 Torx FZB	8	PCS	5707292577818
238	72694	Slidebar	2	PCS	5707292407931
239	72686	Bush for footrest, Toucan	2	PCS	5707292420534
241	0602850	Insex M8*22, FZB	2	PCS	5707292435408
242	72703	End bush with ball	1	PCS	5707292428523
243	72704	Thrust pad	1	PCS	5707292428530
250	72861	Arm	2	PCS	5707292420701
251	1102010	Face plate 8,4*18*2mm, FZB	4	PCS	5707292429766
252	0602800	Insex screw 8*20	2	PCS	5707292138194
253	72694	Slidebar	2	PCS	5707292407931
254	5540515	Strap size 1, knee supp.toucan	2	PCS	5707292434449
255	0602500	insex screw 8*12	2	PCS	5707292138163
256	72862	Angle	2	PCS	5707292420657
257	72863	Disc, for kneesupport	2	PCS	5707292420725
258	72860	Kneesupport size 1	2	PCS	5707292420732
259	0659010	Button head with flange M6*10	4	PCS	5707292356819
260	1101000	Center spring washer 8mm	4	PCS	5707292140173
261	0602700	Insex screw 8*25	2	PCS	5707292138187
270	74062	Toothed disk 30*14	10	PCS	5707292377951
271	72712	Knee joint	2	PCS	5707292420756
272	1102010	Face plate 8,4*18*2mm, FZB	2	PCS	5707292429766
273	0602600	Insex 8*30	2	PCS	5707292138170
274	72713	Bracked	2	PCS	5707292420763
275	0602600	Insex 8*30	2	PCS	5707292138170
276	72694	Slidebar	2	PCS	5707292407931
277	0603000	Insex screw 8*35	2	PCS	5707292138217
278	1607000	Lock nut 8mm, large pack	2	PCS	5707292141378
279	5540220	Girth for kneesupport,size 2+3	2	PCS	5707292178206
280	0640913	Button head/flange M5*10 FZB	4	PCS	5707292558985
288	0631860	Insex 5*10, FZB	4	PCS	5707292139191
289	72716	Tooth brace	2	PCS	5707292420770
290	6175161	Kneesupport size 1 Panda	2	PCS	5707292189288
290	6175162	Kneesupport size 2 Panda	2	PCS	5707292189295
460	72694	Slidebar	2	PCS	5707292407931
461	1607000	Lock nut 8mm, large pack	2	PCS	5707292141378
462	72712	Knee joint	2	PCS	5707292420756
463	1102010	Face plate 8,4*18*2mm, FZB	2	PCS	5707292429766
464	0602600	Insex 8*30	2	PCS	5707292138170
465	74062	Toothed disk 30*14	12	PCS	5707292377951
466	0603000	Insex screw 8*35	2	PCS	5707292138217
467	5540515	Strap size 1, knee supp.toucan	2	PCS	5707292434449
467	5540220	Girth for kneesupport,size 2+3	2	PCS	5707292178206
468	0603000	Insex screw 8*35	2	PCS	5707292138217
469	72713	Bracked	2	PCS	5707292420763
470	0640907	Button head with flange M8*10	4	PCS	5707292441119
472	72751-1	Inner Knee support size 1	2	PCS	5707292506573
472	72753-1	Inner Knee support size 2	2	PCS	5707292506597
472	72755-1	Inner Knee support size 3	2	PCS	5707292506610



473	72752-1	Outer knee support size 1	2	PCS	5707292506580
473	72754-1	Outer knee support size 2	2	PCS	5707292506603
473	72756-1	Outer knee support size 3	2	PCS	5707292506627
474	0631990	Button head with flange M6*8	4	PCS	5707292517333
474	0659010	Button head with flange M6*10	4	PCS	5707292356819

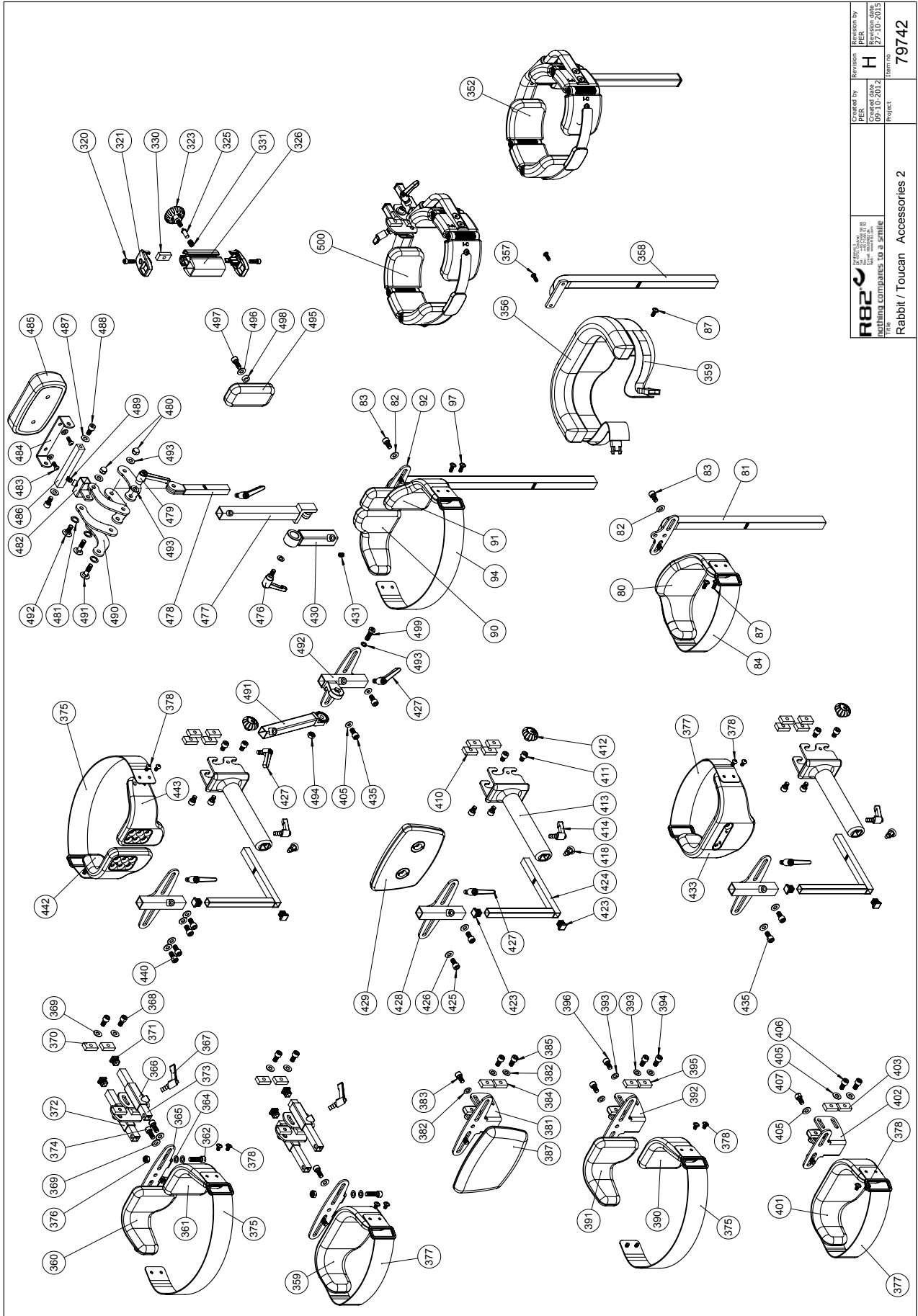

<b>R82</b> Helping you do nothing compares to a smile The Rabbit / Toucan Accessories 2	Prepared by H	Revision by H	Revision H
	Created date 09-10-2012	Revision date 27-10-2015	Item no 79742
Project		Item no	

Position	No.	Description	Quantity	Unit of Measure	Ean code
80	72820	CHESTSUPPORT SIZE 1	1	PCS	5707292421340
81	72783	MOUNTING POLE SIZE 1	1	PCS	5707292421647
82	1102010	FACE PLATE 8,4*18*2MM, FZB	2	PCS	5707292429766
83	0602950	Insex M8*14 mm FZB	2	PCS	5707292564016
84	5540506	STRAP SIZE 1, 80 MM TOUCAN	1	PCS	5707292457363
87	0659011	BUTTON HEAD WITH FLANGE M6*10	4	PCS	5707292505507
90*	72830	CHESTSUPPORT SIZE 2 RIGHT	1	PCS	5707292421357
	72840	CHESTSUPPORT SIZE 3 RIGHT	1	PCS	5707292421371
91*	72831	CHESTSUPPORT SIZE 2 LEFT	1	PCS	5707292421364
	72841	CHESTSUPPORT SIZE 3 LEFT	1	PCS	5707292421388
92	72994	Mounting pole size 1	1	PCS	5707292480255
94	5540508	STRAP SZ.2, 80MM TOUCAN	1	PCS	5707292457370
	5540511	Strap size 3, 80 mm Toucan	1	PCS	5707292457387
97	0659011	BUTTON HEAD WITH FLANGE M6*10	4	PCS	5707292505507
320	0602200	INSEX SCREW 6*16	2	PCS	5707292138095
321	72610	PLUG FOR PILE	2	PCS	5707292420718
323	3502545	R82 HANDLE DIA.45 M8*15MM	1	PCS	5707292450456
325	72611	TRUST PAD	1	PCS	5707292450500
326	72609	PROFILE SIZE 7, 80 MM	1	PCS	5707292438805
330	72694	SLIDEBAR	1	PCS	5707292407931
331	0310521	Compression spring 1.2*8	1	PCS	5707292450463
356	6175190	CHESTSUPPORT F/PONY 0,PU	1	PCS	5707292189325
357	0641600	BUTTON HEAD SCREW 6*16	1	PCS	5707292139269
358	72770	MOUNTING POLE (SIZE 1)	1	PCS	5707292483775
359	72820	Chestsupport size 1	1	PCS	5707292421340
360*	72831	CHESTSUPPORT SIZE 2 LEFT	1	PCS	5707292421364
	72841	CHESTSUPPORT SIZE 3 LEFT	1	PCS	5707292421388
361*	72830	CHESTSUPPORT SIZE 2 RIGHT	1	PCS	5707292421357
	72840	CHESTSUPPORT SIZE 3 RIGHT	1	PCS	5707292421371
362	0602600	INSEX 8*30	2	PCS	5707292138170
364	1310711	NYLON WASHER 15*8,4*1,5MM	4	PCS	5707292429933
365	72904	MOUNTING CROSS	1	PCS	5707292424846
366	72901	BRACKED RIGH,ROTATE HIPSUPPORT	1	PCS	5707292428332
367	3502516	TIGHTENING HANDLE 45MM M8*16	2	PCS	5707292146915
368	0602900	INSEX SCREW 8*16	4	PCS	5707292138200
369	1102010	FACE PLATE 8,4*18*2MM, FZB	6	PCS	5707292429766
370	72694	SLIDEBAR	4	PCS	5707292407931
371	2504000	FERRULE E15*1,0-2,0 INT.BLACK	2	PCS	5707292144102
372	72902	HEIGHT REGULATION, RABBIT	1	PCS	5707292423054
373	72903	LASER CUT PIPE 15*15*1,5*100	2	PCS	5707292424822
374	0602950	Insex M8*14 mm FZB	2	PCS	5707292564016
375*	5540508	STRAP SIZE 2, 80MM TOUCAN	1	PCS	5707292457370
	5540511	STRAP SIZE 3, 80 MM TOUCAN	1	PCS	5707292457387
376	1607000	LOCK NUT 8MM, LARGE PACK	2	PCS	5707292141378
377	5540506	STRAP SIZE 1, 80 MM TOUCAN	1	PCS	5707292457363
378	0659011	BUTTON HEAD WITH FLANGE M6*10	4	PCS	5707292505507
381	72773	MOUNTING CROSS	1	PCS	5707292406194
382	1102010	FACE PLATE 8,4*18*2MM, FZB	6	PCS	5707292429766

383	0602505	Insex M8*18, FZB	2	PCS	5707292420749
384	72694	SLIDEBAR	4	PCS	5707292407931
385	0602900	INSEX SCREW 8*16	4	PCS	5707292138200
387	72850	BACK SUPPORT	1	PCS	5707292423023
390*	72830	CHESTSUPPORT SIZE 2 RIGHT	1	PCS	5707292421357
	72840	CHESTSUPPORT SIZE 3 RIGHT	1	PCS	5707292421371
391*	72831	CHESTSUPPORT SIZE 2 LEFT	1	PCS	5707292421364
	72841	CHESTSUPPORT SIZE 3 LEFT	1	PCS	5707292421388
392	72773	MOUNTING CROSS	1	PCS	5707292406194
393	1102010	FACE PLATE 8,4*18*2MM, FZB	8	PCS	5707292429766
394	0602900	INSEX SCREW 8*16	4	PCS	5707292138200
395	72694	SLIDEBAR	4	PCS	5707292407931
396	0602950	Insex M8*14 mm FZB	4	PCS	5707292564016
401	72820	CHESTSUPPORT SIZE 1	1	PCS	5707292421340
402	72774	MOUNTING CROSS SIZE 1	1	PCS	5707292421609
403	72694	SLIDEBAR	4	PCS	5707292407931
405	1102010	FACE PLATE 8,4*18*2MM, FZB	6	PCS	5707292429766
406	0602900	INSEX SCREW 8*16	4	PCS	5707292138200
407	0602950	Insex M8*14 mm FZB	2	PCS	5707292564016
410	72694	SLIDEBAR	4	PCS	5707292407931
411	0602500	INSEX SCREW 8*12	4	PCS	5707292138163
412	3503001	R82 HANDLE M8*15MM SCREW	1	PCS	5707292413925
413	75300	HANDLE, BACKSUPPORT	1	PCS	5707292510495
414	3502115	TIGHTNING HANDLE M6X15MM	1	PCS	5707292146854
418	0380184	Spec. Locking house M10*1,28mm	1	PCS	5707292366030
423	2504000	FERRULE E15*1,0-2,0 INT.BLACK	1	PCS	5707292144102
424	76556	TUBE ANGLE, BACKSUPPORT	1	PCS	5707292507853
425	0602505	Insex M8*18, FZB	2	PCS	5707292420749
426	1102010	FACE PLATE 8,4*18*2MM, FZB	2	PCS	5707292429766
427	3502516	TIGHTENING HANDLE 45MM M8*16	1	PCS	5707292146915
428	72738	MOUNTING CROSS, BACKSUPPORT	1	PCS	5707292422989
429	72850	BACK SUPPORT	1	PCS	5707292423023
430	72737	MOUNTING FOR HEADSUPPORT	1	PCS	5707292422972
431	0808020	STAINLESS STOPSCREW,M8*12	1	PCS	5707292140074
433	72820	CHESTSUPPORT SIZE 1	1	PCS	5707292421340
435	0602950	Insex M8*14 mm FZB	2	PCS	5707292564016
440	0602950	Insex M8*14 mm FZB	4	PCS	5707292564016
442	72830	CHESTSUPPORT SIZE 2 RIGHT	1	PCS	5707292421357
442	72840	CHESTSUPPORT SIZE 3 RIGHT	1	PCS	5707292421371
443	72831	CHESTSUPPORT SIZE 2 LEFT	1	PCS	5707292421364
443	72841	CHESTSUPPORT SIZE 3 LEFT	1	PCS	5707292421388
475	3502516	TIGHTENING HANDLE 45MM M8*16	2	PCS	5707292146915
476	3502600	TIGHTENING HANDLE 65MM M8*16	2	PCS	5707292146922
477	82563	ARM WITH CONUS	1	PCS	5707292124807
477	82573	ARM WITH CONUS 2+3	1	PCS	5707292124906
478	81123	ROD FOR NECK SUPPORT (STD.NL)	1	PCS	5707292112484
478	81894	ROD FOR NECK SUPPORT, TURTLE	1	PCS	5707292119643
479	3502300	TIGHTENING HANDLE 65MM M8 BUSH	1	PCS	5707292146885
480	1780800	TOP NUT 8MM	2	PCS	5707292141569

481	1102000	PLANING WASHER 8MM	4	PCS	5707292140227
482	81893	ROD FOR NECK SUPPORT	1	PCS	5707292119636
483	0641600	BUTTON HEAD SCREW 6*16	2	PCS	5707292139269
484	81410	U-MOUNTING FOR NECK-SUPPORT	1	PCS	5707292115133
485	6171550	HEADREST SIZE 1,BLACK PUR-FOAM	1	PCS	5707292188786
485	6172550	HEADREST SIZE 2,BLACK PU-FOAM	1	PCS	5707292188823
485	6173550	HEADREST SIZE 3,BLACK PUR-FOAM	1	PCS	5707292188861
485	6174550	HEADREST 4, BLACK PU-FOAM	1	PCS	5707292188908
486	81411	DISTANCE-PIPE F. NECK-MOUNTING	1	PCS	5707292115140
487	1101000	CENTER SPRING WASHER 8MM	2	PCS	5707292140173
488	0602900	INSEX SCREW 8*16	2	PCS	5707292138200
489	0701000	STOP SCREW WITH CRATER 8*10	1	PCS	5707292139870
490	81844	PLATE F.NECKREST, TURTLE	5	PCS	5707292119162
491	75303	BAR WITH FITTING L=335,5 mm	1	PCS	5707292509994
491	75298	BAR WITH FITTING L=200,5 mm	1	PCS	5707292509987
492	75294	MOUNTING CROSS, BACK SUPPORT	1	PCS	5707292509963
493	1100495	SPRING WASHER M8	1	PCS	5707292458674
494	1603500	STEEL NUT 8MM, LARGE PACK	1	PCS	5707292141286
495	72845	CHEST SUPPORT, MID PUR, SIZE 2	1	PCS	5707292445834
495	72846	CHEST SUPPORT, MID PUR, SIZE 3	1	PCS	5707292445841
496	1102010	FACE PLATE 8,4*18*2MM, FZB	1	PCS	5707292429766
497	0602505	Insex M8*18, FZB	1	PCS	5707292420749
498	1350000	DISTANCEPART BLACK 6*15*8,2 MM	1	PCS	5707292140876
499	0602485	INSEX M8*25,LOW HEAD,STAINLESS	1	PCS	5707292432216